

FIGURE 1 – Manibridge Phase One Drill Hole Intersections on Long Section of Mineralization

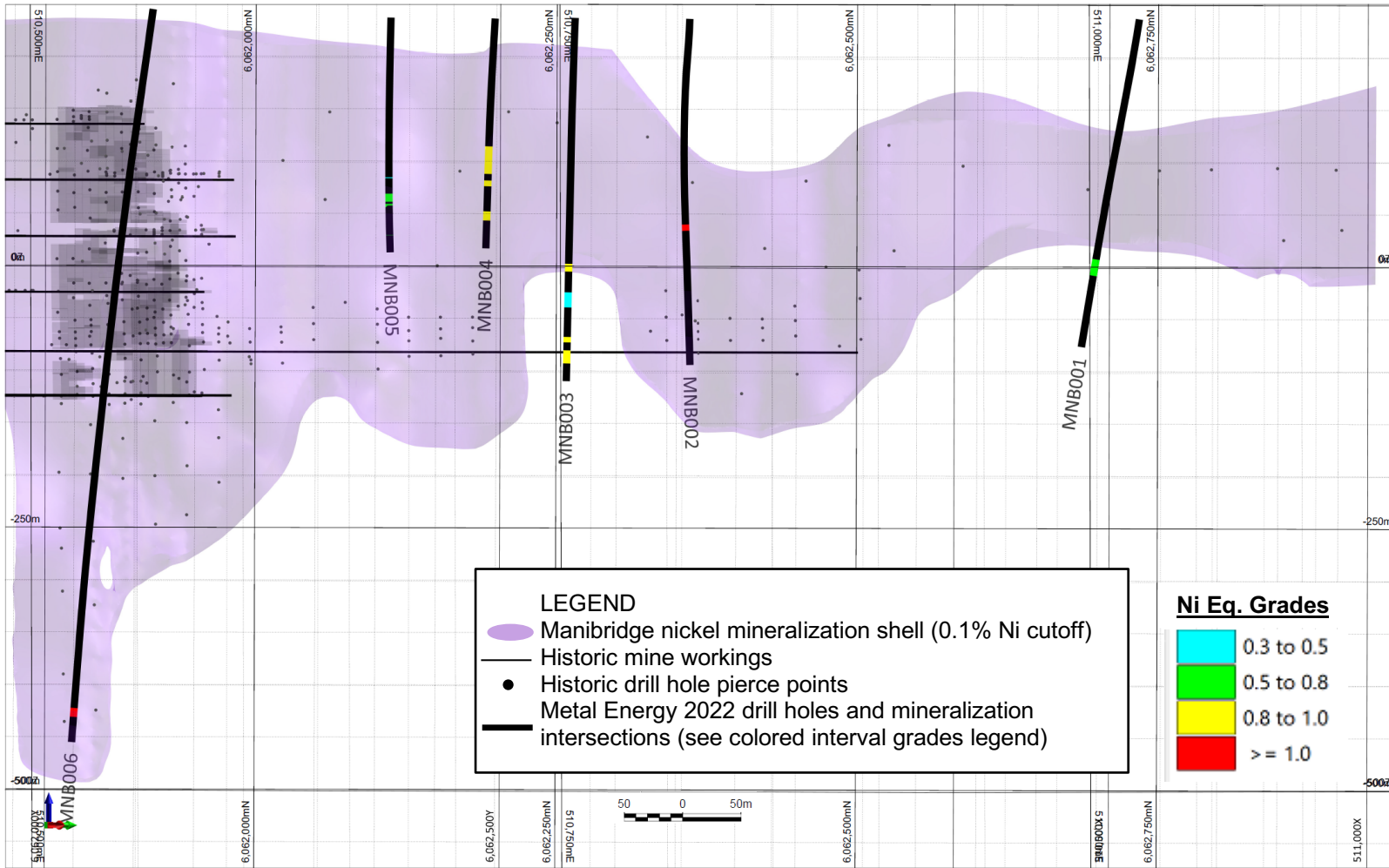

TABLE 1 –Phase One Winter 2022 Diamond Drill Hole Nickel-Copper-Cobalt Mineralization Assay Results

DDH	From	To	Interval	Ni%	Co%	Cu%	Ni eq.%	GT (Ni eq%*m)
MNB001	247.00	263.90	16.90	0.50	0.01	0.01	0.52	8.79
<i>includes</i>	263.45	263.90	0.45	2.36	0.02	0.26	2.46	1.11
	268.90	270.50	1.60	0.32	0.02	0.05	0.36	0.58
MNB002	207.50	213.80	6.30	1.26	0.02	0.04	1.31	8.25
<i>includes</i>	209.50	213.25	3.75	1.63	0.02	0.06	1.69	6.34
MNB003	249.30	257.30	8.00	0.92	0.02	0.03	0.96	7.68
<i>includes</i>	249.30	253.30	4.00	1.26	0.02	0.06	1.30	5.20
	278.50	293.85	15.35	0.36	0.02	0.02	0.40	6.14
	323.85	329.50	5.65	0.93	0.02	0.03	0.97	5.48
<i>includes</i>	324.85	328.50	3.65	1.26	0.02	0.05	1.31	4.78
	337.50	351.00	13.50	0.77	0.01	0.04	0.81	10.94
<i>includes</i>	343.50	344.50	1.00	1.11	0.02	0.05	1.16	1.16
<i>and</i>	346.50	347.50	1.00	1.32	0.02	0.09	1.38	1.38
MNB004	150.45	183.40	32.95	0.88	0.02	0.03	0.92	30.31
<i>includes</i>	153.45	154.45	1.00	1.07	0.03	0.05	1.13	1.13
<i>and</i>	163.45	166.45	3.00	1.35	0.02	0.04	1.41	4.23
<i>and</i>	169.10	180.55	11.45	1.20	0.02	0.04	1.24	14.20
	191.10	198.10	7.00	0.83	0.02	0.03	0.87	6.09
<i>includes</i>	193.10	197.10	4.00	1.07	0.02	0.04	1.12	4.48
	227.95	239.00	11.05	0.80	0.02	0.05	0.84	9.28
<i>includes</i>	233.10	238.20	5.10	1.26	0.02	0.10	1.33	6.78
MNB005	193.50	194.50	1.00	0.39	0.01	0.01	0.41	0.41
	213.20	223.00	9.80	0.65	0.01	0.01	0.68	6.66
<i>includes</i>	213.20	213.70	0.50	1.45	0.03	0.16	1.54	0.77
	225.50	227.50	2.00	0.59	0.01	0.01	0.61	1.22
	263.10	263.50	0.40	0.40	0.02	0.05	0.52	0.21
MNB006	700.00	709.00	9.00	1.08	0.02	0.07	1.13	10.17
<i>includes</i>	701.00	706.00	5.00	1.55	0.03	0.09	1.62	8.10

NOTES:

1. Ni% cutoff grade is 0.30%
2. Ni% cutoff grade for *includes/and* is 1.00% Ni
3. Reported widths do not contain greater than 2 m of consecutive core with less than cutoff grades
4. Ni eq.% is calculated as the sum of Ni% + Co% * (\$50,354/\$27,065) + Cu% * (\$6,680/\$27,065)
5. Price of Ni = \$27,065/metric ton, price of Co = \$50,354/metric ton, price of Cu = \$6,680/metric ton
6. Metal prices were derived from Shanghai Metal Market website (www.metal.com) on July 22, 2022
7. Ni = nickel, Co = cobalt, Cu = copper

TABLE 2 –Phase One Winter 2022 Diamond Drill Hole Collar Location Information

DDH	Target Area	East	North	Elevation	Azimuth	Dip	EOH
MNB001	Manibridge Mine	511,145	6,062,665	236	272	-72	338
MNB002	Manibridge Mine	510,891	6,062,315	236	293.5	-73	352
MNB003	Manibridge Mine	510,854	6,062,210	237	292	-73	369
MNB004	Manibridge Mine	510,762	6,062,175	236	295	-56	272
MNB005	Manibridge Mine	510,723	6,062,083	237	298	-53	284
MNB006	Manibridge Mine	510,936	6,061,699	244	268	-75	735
6 DDH							2,350.0

NOTES: East and North units are metres using NAD83 datum, UTM Zone 14N

Elevation is recorded as "metres above sea level"

EOH = End of hole, measured in metres